

Hammer Mill Hippo 1

MH 1 - Hammer Mill Hippo 1

Powered by 12HP Petrol **YAMAHA** Engine or 12HP JD diesel or 7.5 or 9kw
3 phase electric motor

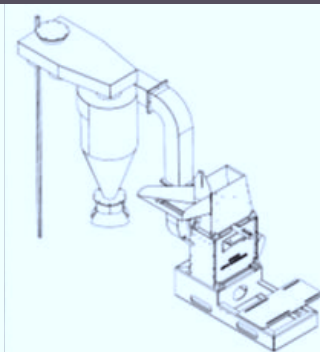

The design of the HIPPO HAMMER MILL is unique in that there are no chopping knives, as the material is being fed directly onto the tips of the rotating hammers in the direction in which the hammers are rotating. The milled material is transported from the bottom of the

mill housing by means of an optional separate four-bladed fan mounted on the same shaft as the rotor and delivered to the cyclone. A wide range of screens is available, from 25mm down to 0.6mm aperture. The mills are all a bolt together construction, which gives the mill an exceptionally long lifespan, and make replacing of parts easy and quick.

HIPPO HAMMERMILLS have been manufactured in South Africa since 1928, and parts are readily available from our warehouse, usually within 24 hour from order. HIPPO HAMMERMILLS from models Baby up to Size 69 are based on cast iron milling plates, which drastically increases the lifespan of the mill, compared to competitors. The Hippo 1 is a mid range agricultural mill, with medium capacity and high quality parts. All milling tips are manufactured from Bennox steel to ensure long lifetime on these parts.

Power required:	9kW or 7.5kW 3 Phase 380 V Electric / 12 HP Diesel	
Capacity:	0.8mm Screen	250kg/hr
	1.6mm Screen	500 kg/hr
	8mm Screen	1100kg/hr
	Capacity is based on dry maize with the 7.5kw electric model	
Length:	2,364mm	
Width:	1,225mm	
Height:	2,167mm	
Net weight:	225kg	
Rotor diameter:	315mm	
Number of beaters:	6	
Number of tips:	24	
Tip Speed:	78 m/s	
RPM	4500 RPM	
Consumables:	Tips/Beater Centres/V-Belts/Bearings/Screens	
Screen Area:	1104 cm ²	

Capacities and specifications shown are indicative only and may change without notice. Copyright ABC Hansen Africa (Pty) Ltd 2020

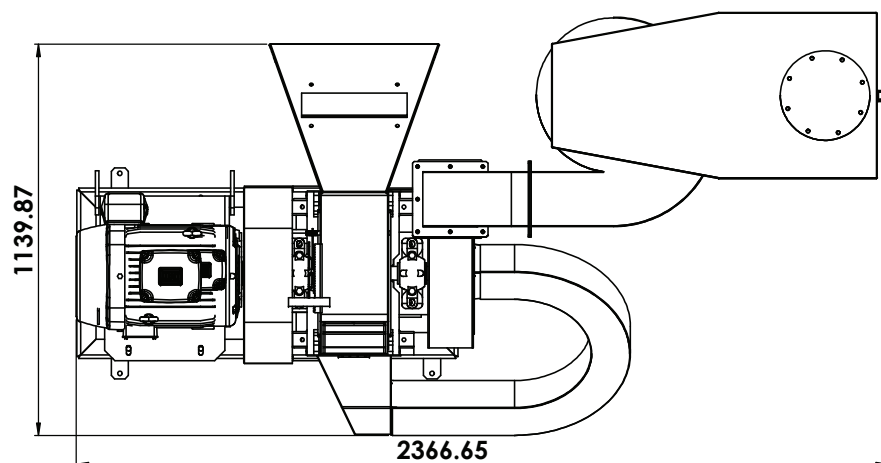
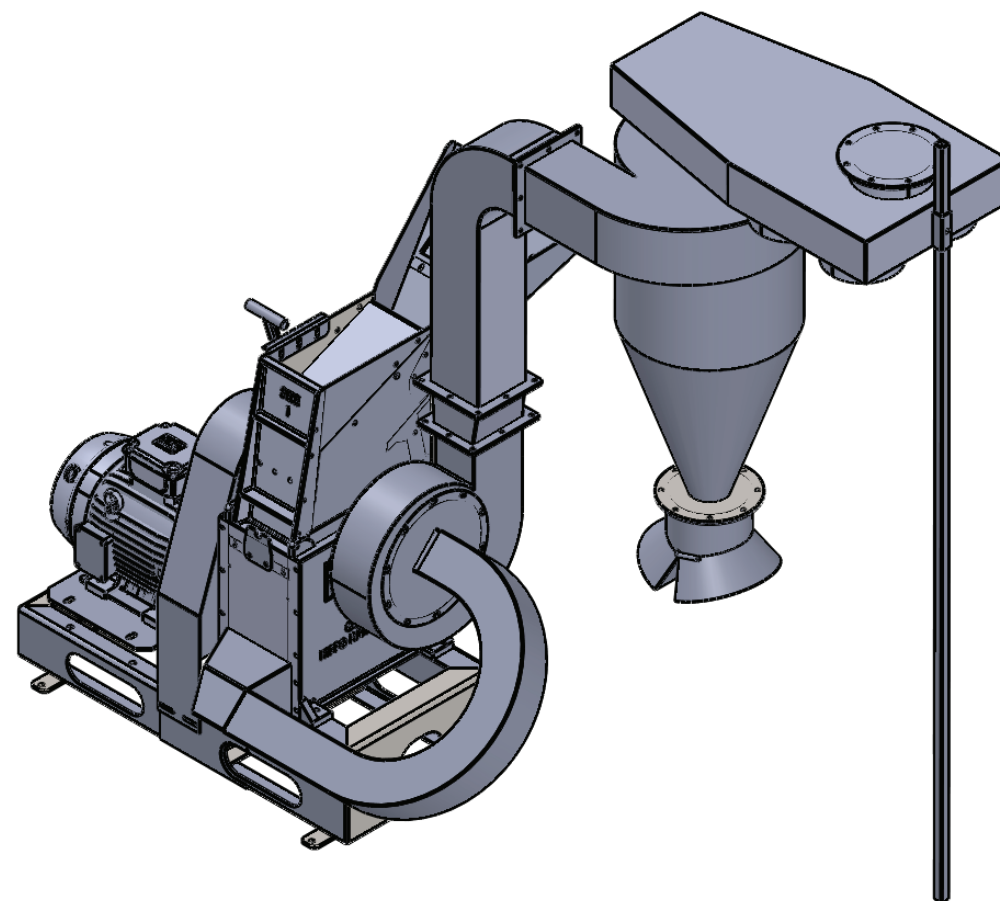
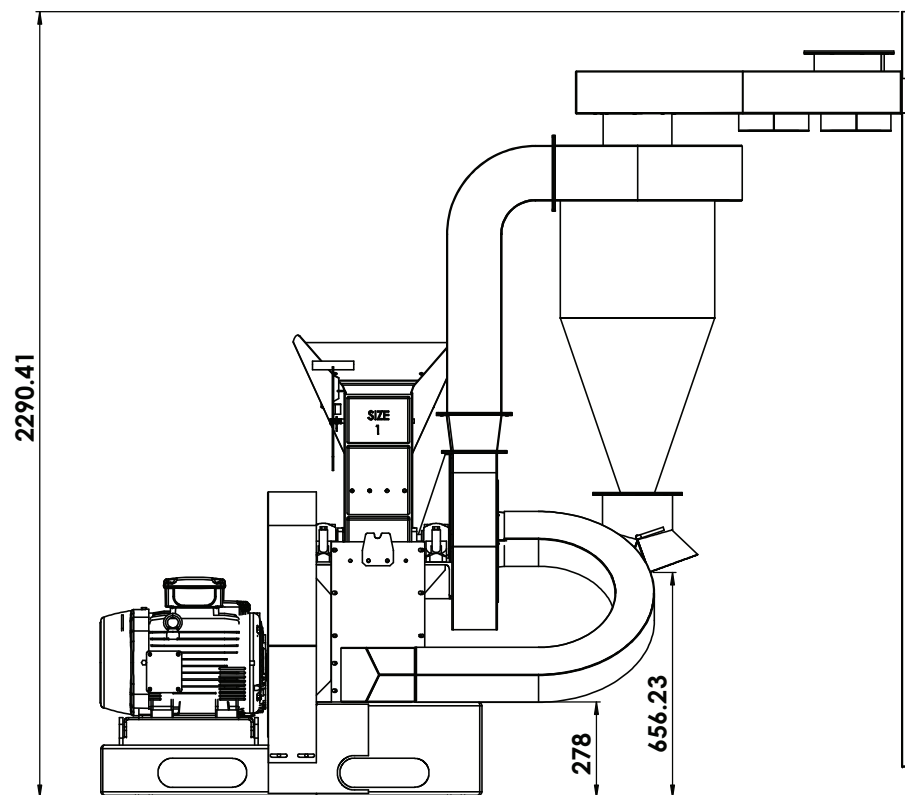

ABC Africa Group

UNLESS OTHERWISE SPECIFIED: DIMENSIONS ARE IN MILLIMETERS				FINISH:		DEBUR AND BREAK SHARP EDGES		DO NOT SCALE DRAWING		REVISION	
SURFACE FINISH: TOLERANCES: LINEAR: ANGULAR:											
	NAME	SIGNATURE	DATE			TITLE:					
DRAWN						<div style="display: flex; justify-content: space-between;"> <div>MATERIAL:</div> <div>HWY:PC</div> <div>A2</div> </div> <div style="text-align: center; font-size: 2em; font-weight: bold;">HPM-01-000-000_Electric</div>					
CHK'D											
APP'VD											
MFG											
Q.A.											
						WEIGHT:					
						SCALE:1:5				SHEET 1 OF 1	